

MODEL 28 CENTER HUNG

Application

Single Acting, Handed
Exterior or Interior Doors
Weight to 350 lbs.
Sizes up to 4'0"x8'6"***
(1219x2591mm)



ANSI/C06021

Product Description & Features

- Built-in positive dead stop prevents door from swinging beyond the desired opening degree (specify 85, 90, 95 or 105°)
- Separate and independent valves for closing speed, latch speed and backcheck
- Delayed action available-prefix "DA"
- Available non hold-open (NHO), automatic hold open (AHO) or selective hold open (SHO) at same degree as dead stop
- Models available to meet ANSI A117.1 opening force requirements. Prefix "PH"
- Cold weather fluid available-specify "CWF" (not available for closers with "DA")
- Sealed closer available-specify "SC"
- Available with floor plate or threshold installation (floor plate shown)
- Cylolac cement case
- Arm centering adjustment
- Arm reinforcement bracket for wood doors - prefix "W"
- Standard top pivot: #340 included
- Not allowed for fire rated doors
- Applied stop required (see part # 60131 on page 34)

Technical Information

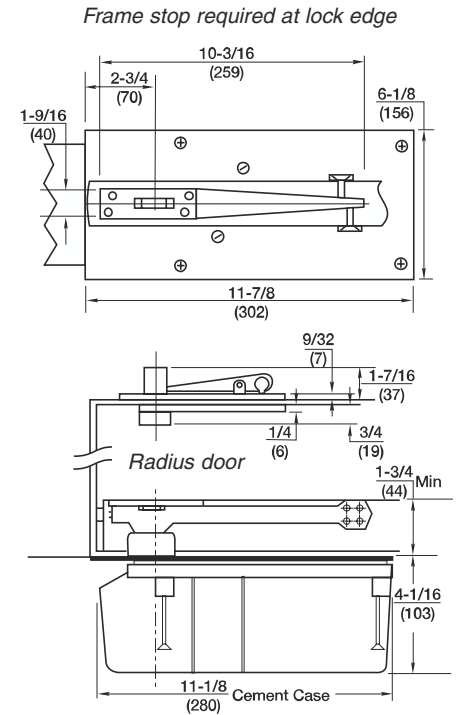

Extended spindles available in 1/2"(13mm) increments up to 2"(51mm)

Furnished with wood and machine screws

* For doors taller than 8'6" use top pivot # 345 in lieu of 340

MODEL 28 x 554 ARM CENTER HUNG

Application

Fully Concealed Arm



ANSI/C06021

Product Description & Features

- Identical to Model 28 except:
- Arm is designed to eliminate visible adjusting screws on face of door
 - Arm bolt locks arm to closer spindle -adjustments made through heel of door

Technical Information

